

Rubn®

DESIGN NICLAS HOFLIN

— INSTALLATION INSTRUCTION —

VOX WALL

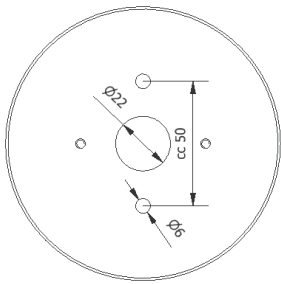

1. Rotate and remove glass.
2. Loosen 2pc screw-nut **A** and remove socket **B** to access holes on wallcup.
3. Fix cup by using 2pc screws (not included) then connect cables to plinth behind socket **B**.
Re-assemble previous steps 2 and 1 and add light source.

